

Pump Repair

Models: LGF1D, LGB1D, LGF1PD & LGB1PD

blackmer

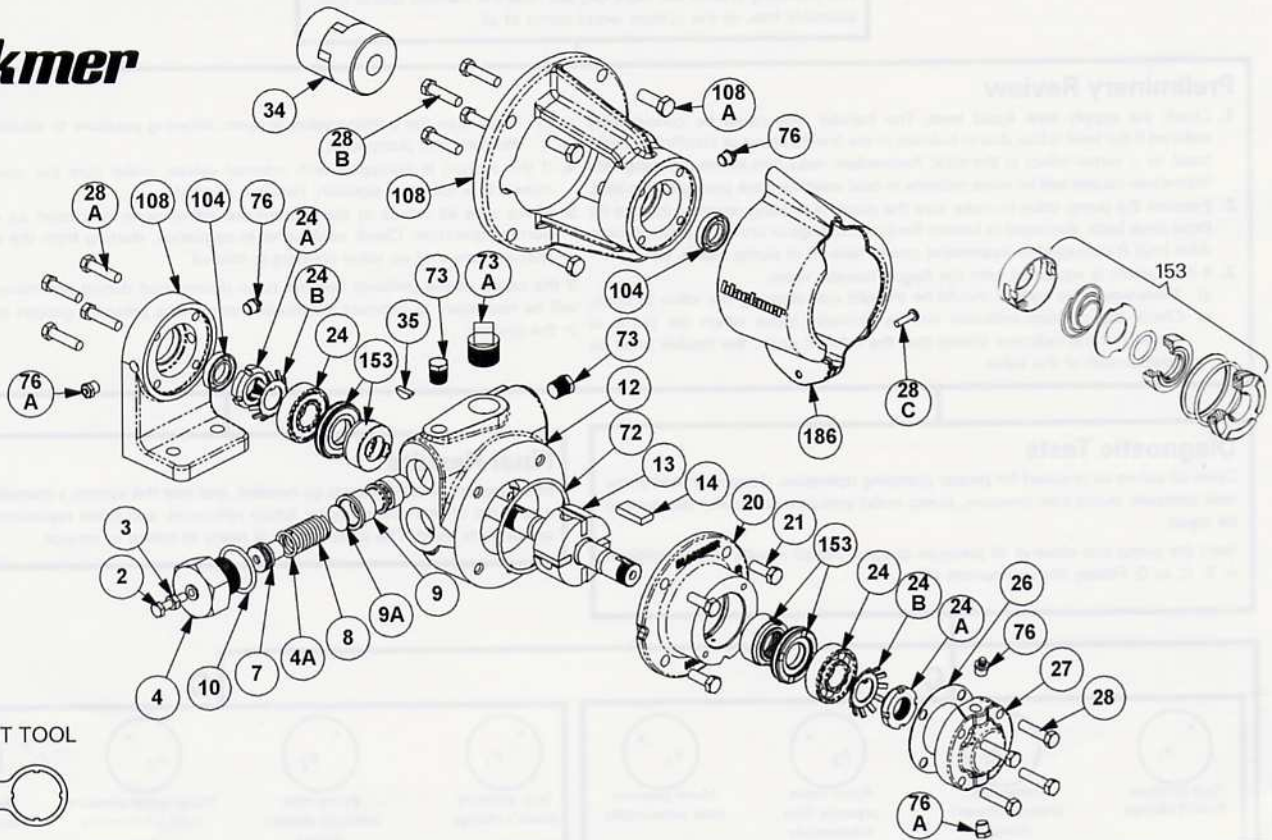

Ref. No.	Description	Parts per Pump	Part No.	Ref. No.	Description	Parts per Pump	Part No.
2	Adjusting Screw – Relief Valve (R/V)	1	432901	28 [†]	Capscrews – Bearing Cover	4	920080
3	Locknut – Adjusting Screw	1	922811	28A [†]	Bracket Mounting Screws	4	920090
4	Cover – R/V	1	412901	28B [†]	Bracket Mounting Screws	4	920101
4A	O-Ring – Spring Guide	1	711940	28C	Guard Screw	1	920026
7	Spring Guide – R/V	1	422901	34	Coupling Half – Pump	1	906150
8	Spring – R/V	1	472901		Coupling Half – Motor (56C)		906151
9	Valve – R/V	1	452901		Coupling Half – Motor (143-145TC/184C)		906147
9A	Disc – R/V	1	442901		Coupling Spider		906155
10	O-Ring – R/V Cover	1	701965	35	Key – Shaft	1	909126
12 [†]	Cylinder – LGF1, LGB1	1	022914	72	O-Ring – Head	1	711941
	Cylinder – LGF1P, LGB1P		022915	73	Gage Plug (1/4")	2	908198
13	Rotor & Shaft Assembly (Includes Ref. Nos. 24A & 24B)	1	262901	73A [†]	Gage Plug (3/4")	1	908225
14	Vane – Duravane (Std.)	4	092912	76	Grease Fitting	2	317815
20 [†]	Head	1	032905	76A	Grease Relief Fitting	2	701992
21	Capscrews – Head	4	920178	104	Grease Seal	1	331934
24	Ball Bearing	2	903405	108	Bracket - (base mount) - LGB1(P)D	1	832913
24A	Locknut – Bearing	2	903531		Bracket (c-faced footless) - LGF1(P)D		832912
24B	Lockwasher – Bearing	2	903532	108A	Capscrews – Bracket	4	920331
26 [†]	Gasket – Bearing Cover	1	383075	108B	Bracket (C-faced footed)	1	833000
27 [†]	Bearing Cover	1	043071	186	Guard	1	804120
					Tool - Locknut		903090
				153	Mechanical Seal Assembly	2	332930
					Kit - Maintenance		898916

[†] Included in Maintenance Kit. [†] To fit the LGB1(P)C, LGF1(P)C use: Ref. No. 12-022902/022911 respectively, Ref. No. 20-032902, Ref. No. 26-382901, Ref. No. 27-042901, Ref. No. 28-920203, Ref. No. 28A & B-920230, Ref. No. 73A-908198, and Ref. No. 108-832901/832905 respectively.