

Pump Repair

Model: TLGLF3C

blackmer

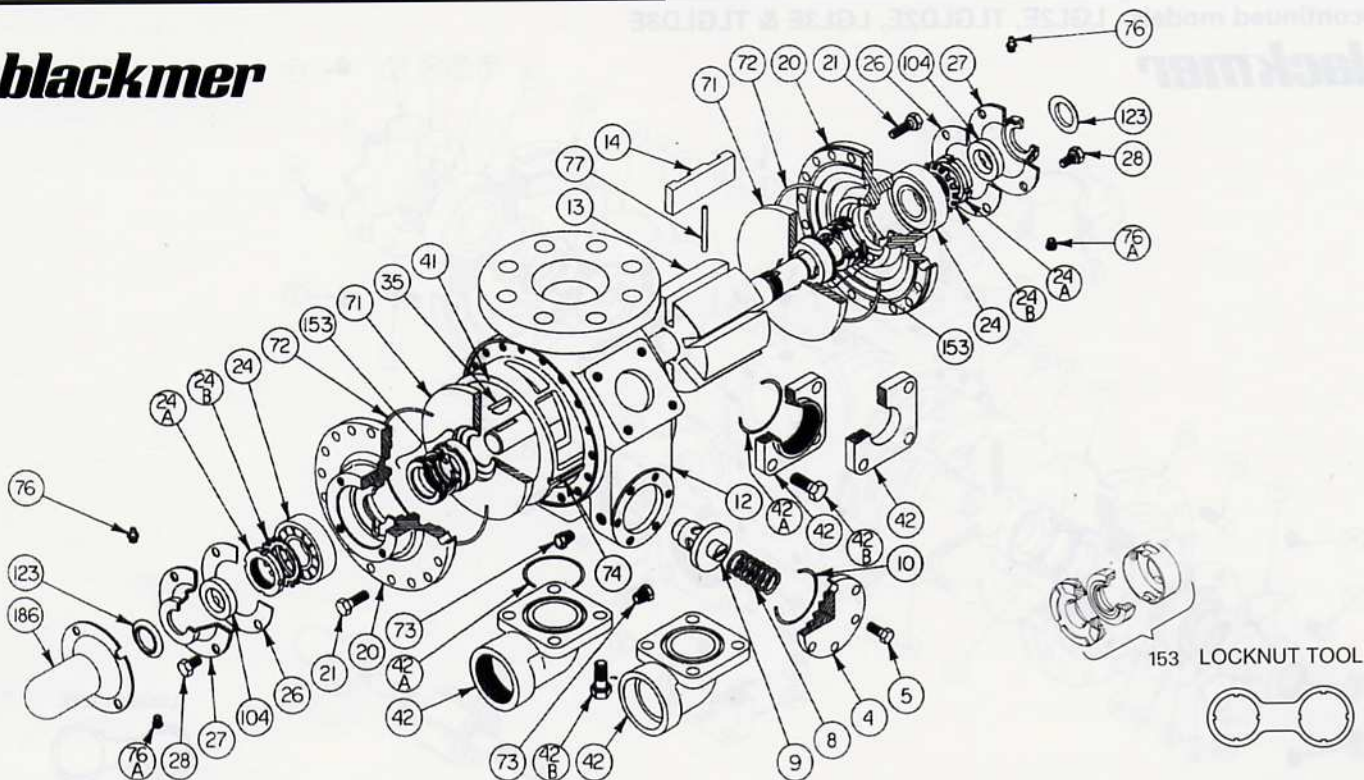

Ref. No.	Description	Parts Per Pump	Part No.	Ref. No.	Description	Parts Per Pump	Part No.
4	Cover - Relief Valve (R/V)	1	⁴ 415108	42	Flange - 2" NPT	1-2	652010
5	Capscrew - R/V Cover	6	920331		Flange - 2" Weld		652024
8	Spring - R/V	1	⁴ 471428		Flanged Elbow - 2" NPT		655100
9	Valve - R/V (Std.)	1	⁴ 451417		Flanged Elbow - 2" Weld		655109
	Valve - R/V (Nickel Plated)		451415				
10	O-Ring - R/V Cover	1	¹ 701919	42A	O-Ring - Flange 2 1/2" x 2 3/4"	2	¹ 701919
12	Casing	1	015128		O-Ring - Flange 2 5/8" x 2 7/8"	2	^{1,3} 702004
13	Rotor & Shaft Assembly (Includes Ref. No. 24A & 24B)	1	265147	42B	Capscrew - Flange, Flanged Elbow	8	920491
14	Vane - Duravane	6	¹ 095132	71	Disc2		¹ 065121
20	Head	2	035132	72	O-Ring - Head	2	¹ 711923
21	Capscrews - Head	36	920351	73	Gage Plug	2	908198
24	Ball Bearing	2	¹ 903156	74	Key - Liner	1	185193
24A	Locknut - Bearing	2	903521	76	Grease Fitting	2	317815
24B	Lockwasher - Bearing	1	¹ 903522	76A	Grease Relief Fitting	2	701992
26	Gasket - Bearing Cover	2	¹ 383940	77	Push Rod	3	¹ 121607
27	Bearing Cover	2	041431	104	Grease Seal	2	¹ 331918
28	Capscrews - Bearing Cover	8	920285	123	Dirt Shield	2	¹ 701480
35	Key - Shaft	1	¹ 909130	186	Shaft Protector	1	341601
41	Liner	1	185101		Tool - Locknut		903091
				153	Mechanical Seal Assembly Dual Service LPG or NH ₃	2	¹ 334439
					Kit - Maintenance - Dual Service LPG or NH ₃		898980

¹ Included in Maintenance Kit

³ Larger O-Ring introduced October 2002

⁴ Additional Parts Included in Maintenance Kit with R/V .