

# Pump Repair

**Models: TLGLF4A**

Discontinued models: TLGLF4

**blackmer**

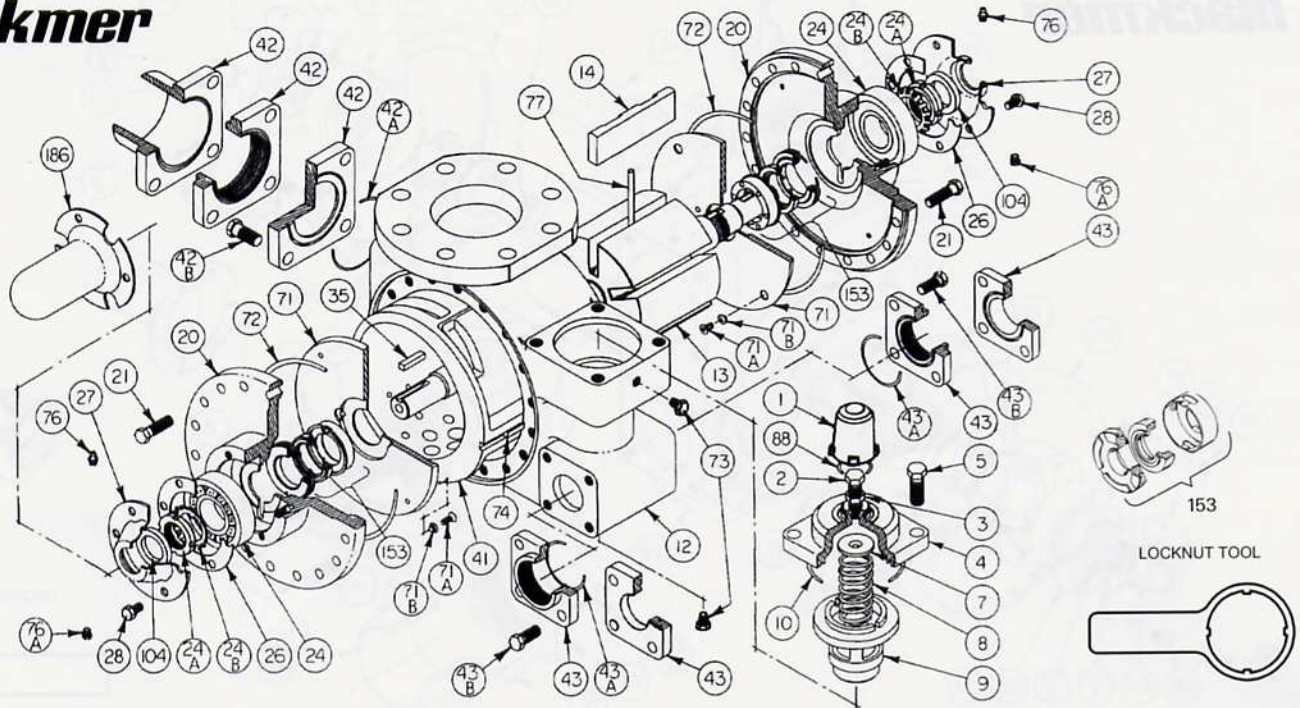

Ref. No.	Description	Parts Per Pump	TLGLF4A Part No.	TLGLF4 Part No.	Ref. No.	Description	Parts Per Pump	TLGLF4A Part No.	TLGLF4 Part No.
1	Cap - Relief Valve (R/V)	1	413952	413952	42A	O-Ring - Flange	1	701937	701937
2	Adjusting Screw - R/V	1	436310	436307		Capscrew - 3" NPT Flange		920663	920663
3	Locknut - Adjusting Screw	1	432039	436355	42B	Capscrew - 3", 4" Weld Flange; Blank Flange	4	920640	920640
4	Cover - RV1	1	412001	412001	<b>TWIN DISCHARGE PORT OPTIONS</b>				
5	Capscrews - R/V Cover	4	920663	920663	43	Flange - 2" NPT	2	652010	652010
7	Spring Guide - R/V	1	426355	426355		Flange - 2" Weld		652024	652024
8	Spring - R/V	1	472039	472039	43A	O-Ring - 2" Flange 2 1/2" x 2 3/4"	2	701919	701919
9	Valve - R/V	1	452001	452001		O-Ring - 2" Flange 2 5/8" x 2 7/8"	2	702004	702004
10	O-Ring - R/V Cover	1	701946	701946	43B	Capscrew - Discharge Flange	8	920491	920491
12	Casing	1	012039	012039	71	Disc	2	062039	062039
13	Rotor & Shaft Asy. (includes Ref. No. 24A & 24B)	1	262024	262022	71A	Machine Screw - Disc	8	920007	920007
14	Vane - Duravane (Std.)	6	092019	092019	71B	Lockwasher - Machine Screw	8	909634	909634
20	Head	2	032039	032039	72	O-Ring - Head	2	702039	702039
21	Capscrews - Head	36	920532	920532	73	Gage Plug	2	908198	908198
24	Ball Bearing	2	903172	903172	74	Key - Liner	1	182040	182040
24A	Locknut - Bearing	2	903541	903523	76	Grease Fitting	2	317815	317815
24B	Lockwasher - Bearing	2	903542	903524	76A	Grease Relief Fitting	2	701992	701992
26	Gasket - Bearing Cover	2	385125	385125	77	Push Rod	3	122005	122001
27	Bearing Cover	2	041815	041815	88	O-Ring - R/V Cap	1	701926	701926
28	Capscrews - Bearing Cover	12	920286	920286	104	Grease Seal	2	331908	331908
35	Key - Shaft	1	909183	909183	186	Shaft, Protector	1	341801	341801
41	Liner	1	182000	182039		Tool - Locknut		903092	903091
<b>AUXILIARY INTAKE OPTIONS</b>					153	Mechanical Seal Assembly	2	332050	332050
42	Flange - 3" NPT	1	652012	652012		Kit - Maintenance		898922	N/A
	Flange - 4" Weld		652005	652005	1 Included in Maintenance Kit				
	Flange - 3" Weld		652007	652007	3 Larger O-Ring introduced October 2002				
	Flange - Blank		652000	652000					