

# 1600AN

The 1600AN Series Adaptor is specifically designed to mate with OPW Kamvalok® Couplings to help prevent liquid spillage during the connection/disconnection process. The adaptor contains a spring-loaded poppet to assure fast closing and tight seal.

## Benefits

- **Single Piece Design** – Eliminates a possible leak path
- **Spill Prevention** – Poppet-actuated design can only be opened with a ® coupling; designed to provide a tight seal when closed.
- **Reliability of Operation** – The simple spring-loaded poppet design and heavy-duty construction provide for reliable, long-life operation.
- **Optimum Flow Rate** – Even flow and low pressure drop are achieved by a built-in deflector that reduces turbulence.

## Features

- **Heavy-Duty Construction** – Available in aluminum, and 316 stainless steel construction.
- **Female Threads** – Can be fitted to either a male pipe end or to a hose fitting.
- **Flanged End** – Available for specific operations, including in-plant and transportation.
- **Spring-Loaded Poppet Design** – Assures fast closing and tight seal.
- **Wide Range of Seals** – Available in Buna-N, Viton®, Teflon®, EPT, Chemraz®.

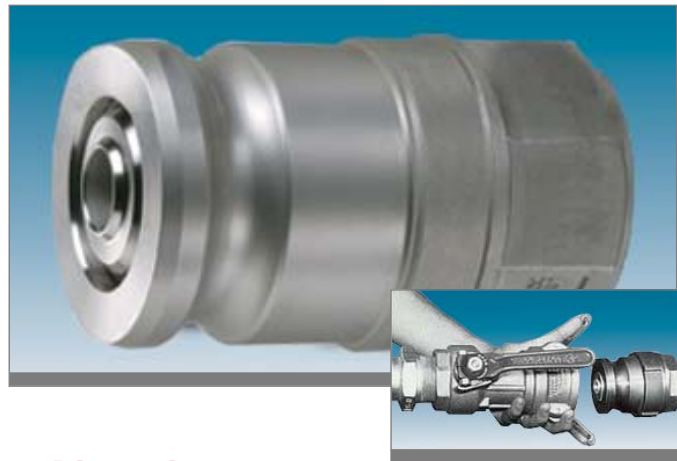

## Dimensions

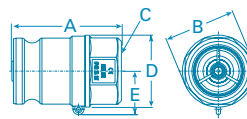

1611AN - 1679AN

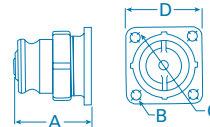

1661SFN

### SIZE IN INCHES (Nominal)

	1 1/2"	2"	3"
<b>A</b>	4-3/4"	4-15/16"	6-17/32"
<b>B</b>	2-1/2"	3-1/4"	4-1/2"
<b>C</b>	1-1/2"	2"	3"
<b>D</b>	2-21/32"	3-1/4"	4-7/8"

### SIZE IN INCHES (Nominal)

	2"
<b>A</b> Overall Length	4-1/4"
<b>B</b> Diameter of Bolt Holes	9/16"
<b>C</b> Bolt Circle	4-1/2"
<b>D</b> Square Flange	4-1/4"

## Ordering Specifications

### Stainless Steel Adaptors - Female NPT

Prod. No.	Size/Description
1671AN-SS15	1-1/2" Buna Seal, Stainless Steel
1671AN-SS20	2" Buna Seal, Stainless Steel
1671AN-SS30	3" Buna Seal, Stainless Steel
1672AN-SS15	1-1/2" Viton® Seal, Stainless Steel
1672AN-SS20	2" Viton® Seal, Stainless Steel
1672AN-SS30	3" Viton® Seal, Stainless Steel
1673AN-SS15	1-1/2" Teflon® Silicone Seal, Stainless Steel
1673AN-SS20	2" Teflon® Silicone Seal, Stainless Steel
1673AN-SS30	3" Teflon® Silicone Seal, Stainless Steel
1674AN-SS15	1-1/2" EPT Seal, Stainless Steel
1674AN-SS20	2" EPT Seal, Stainless Steel
1674AN-SS30	3" EPT Seal, Stainless Steel
1676AN-SS15	1-1/2" Chemraz® Seal, Stainless Steel
1676AN-SS20	2" Chemraz® Seal, Stainless Steel
1676AN-SS30	3" Chemraz® Seal, Stainless Steel
1677AN-SS15	1-1/2" Teflon®-Viton® Seal, Stainless Steel
1677AN-SS20	2" Teflon®-Viton® Seal, Stainless Steel
1677AN-SS30	3" Teflon®-Viton® Seal, Stainless Steel
1679AN-SS15	1-1/2" Viton®-B Seal, Stainless Steel
1679AN-SS20	2" Viton®-B Seal, Stainless Steel
1679AN-SS30	3" Viton®-B Seal, Stainless Steel

### Aluminum Adaptors - Female NPT

Prod. No.	Size/Description
1611AN-AL15	1-1/2" Buna Seal, Alum. & Stainless Steel
1611AN-AL20	2" Buna Seal, Alum. & Stainless Steel
1611AN-AL30	3" Buna Seal, Alum. & Stainless Steel
1612AN-AL15	1-1/2" Viton® Seal, Alum. & Stainless Steel
1612AN-AL20	2" Viton® Seal, Alum. & Stainless Steel
1612AN-AL30	3" Viton® Seal, Alum. & Stainless Steel
1612A-AL07	3/4" Viton® Seal, Alum. & Stainless Steel
1613AN-AL15	1-1/2" Teflon® Seal, Alum. & Stainless Steel
1613AN-AL20	2" Teflon® Seal, Alum. & Stainless Steel
1613AN-AL30	3" Teflon® Seal, Alum. & Stainless Steel
1614AN-AL15	1-1/2" EPT Seal, Alum. & Stainless Steel
1614AN-AL20	2" EPT Seal, Alum. & Stainless Steel
1614AN-AL30	3" EPT Seal, Alum. & Stainless Steel
1616AN-AL15	1-1/2" Chemraz® Seal, Alum. & Stainless Steel
1616AN-AL20	2" Chemraz® Seal, Alum. & Stainless Steel
1616AN-AL30	3" Chemraz® Seal, Alum. & Stainless Steel
1619A-AL07	3/4" Viton®-B Seal, Alum.
1619AN-AL15	1-1/2" Viton®-B Seal, Alum.
1619AN-AL20	2" Viton®-B Seal, Alum.
1619AN-AL30	3" Viton®-B Seal, Alum.