

1½" ROTARY METER - GEAR DRIVE  
 MODEL #1450-15

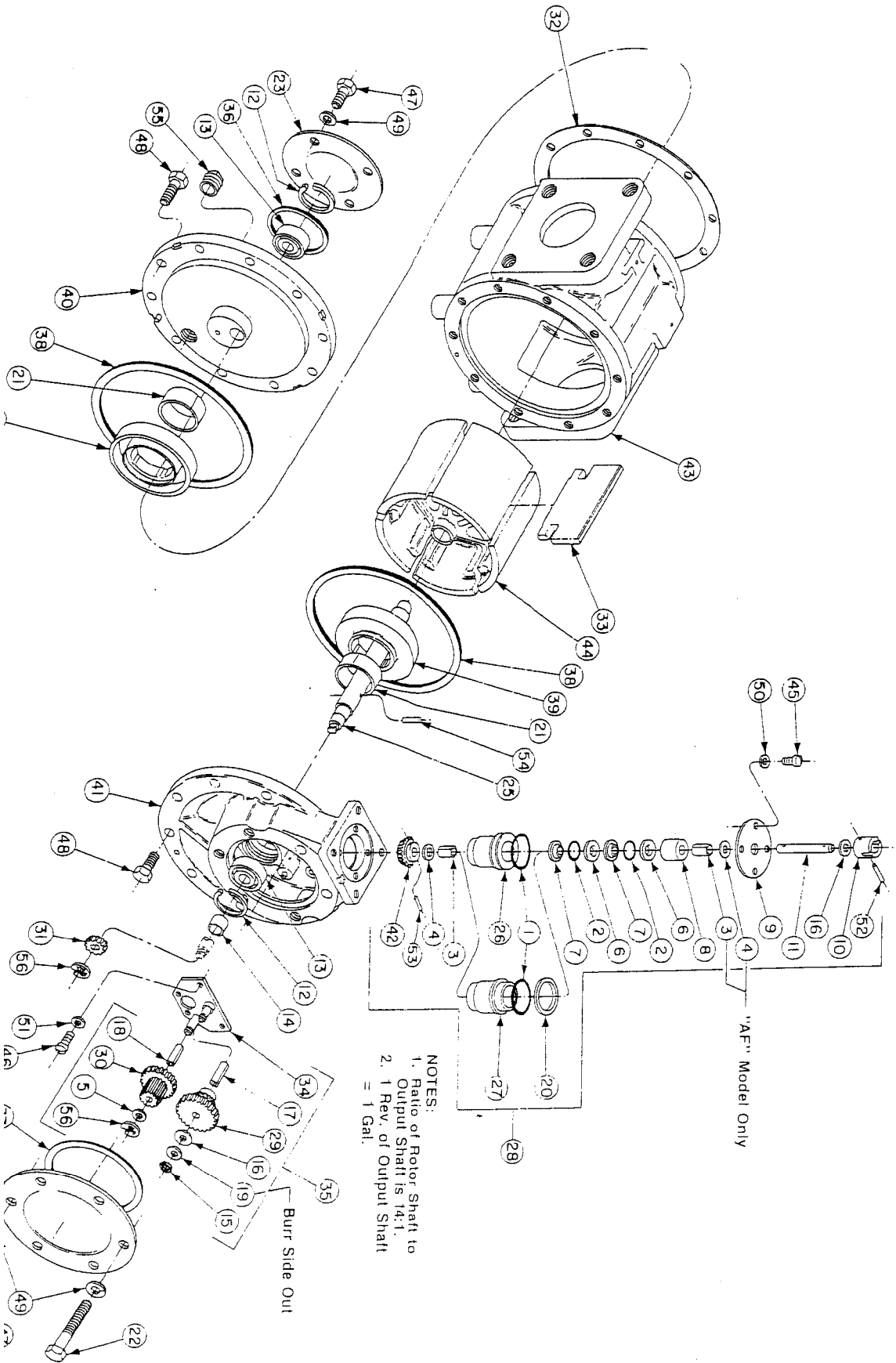

1 1/2" ROTARY METER - GEAR DRIVE MODEL #1450-15

ITEM NO.	NAME OF PART	MODEL 1450-SP	MODEL 1450-AF
1	"O" Ring	503-27-005	503-27-210
2	"O" Ring	503-27-125	503-27-206
3	Bearing Insert	504-26-865	504-26-865
4	Washer	562-03-662	562-03-662
5	Washer	562-03-670	562-03-670
6	Seal	502-26-480	502-26-480
7	Seal Retaining Ring	504-28-995	504-28-995
8	Upper Bearing OR Upper Bearing Assembly- (Includes Item 3)	504-28-820	—
9	Packing Gland Plate	350-02-715	350-02-715
10	Coupling	504-27-150	504-27-150
11	Drive Shaft	504-28-255	504-28-255
12	Retaining Ring	504-08-006	504-08-006
13	Bearing	504-26-710	504-26-710
14	Spacer	504-28-640	504-28-640
15	Retaining Ring	504-08-014	504-08-014
16	Washer	562-03-676	562-03-676
17	Bearing Insert	504-26-810	504-26-810
18	Bearing Insert	504-26-785	504-26-785
19	Washer	562-03-672	562-03-672
* 20	Back-Up Ring	—	504-26-655
21	Bearing Insert	504-08-160	504-26-840
22	Seal Screw	350-00-220	350-01-082
23	Bearing Cover	350-00-510	350-00-220
24	Inspection Cover Rotor Shaft Assembly (Includes Item 54)	350-00-480	350-00-485
25	Packing Capsule (For "AF" & Teflon-Trimmed "Sp" Meters)	504-27-955	—
26	Packing Capsule (For "AF" & Teflon-Trimmed "Sp" Meters)	504-27-970	504-27-970
27	Packing Capsule Assembly (For "AF" & Teflon-Trimmed "Sp" Meters)	350-02-710	—
28	Gear Assembly Includes Item 17	350-00-315	350-00-325

ITEM NO.	NAME OF PART	MODEL 1450-SP	MODEL 1450-AF
30	Gear Assembly (42/12 Teeth)- Includes Item 18	350-00-320	350-00-330
31	Gear (12 Teeth) <i>52775</i>	504-27-415	504-27-410
32	Shim (Specify Quantity Of Each Color Required) "Red", "Green", "A", "B", "C", "D"	504-28-500	504-28-500
33	Blade (Note: Proper Blade Selection Determined By Using Blade Identifier Letter Stamped On Serial No. Plate)	350-00-105	350-00-105
34	Gear Plate & Shaft Assembly	350-00-385	350-00-405
35	Gear Train Assembly	350-00-400	350-00-410
* 36	Gasket	502-26-320	502-26-220
* 37	Gasket	502-26-340	502-26-250
* 38	Gasket	502-26-355	502-26-270
39	Blade Ring Or Blade Ring Assembly (Includes Item 21)	350-00-150	—
40	Cover Assembly - (Includes Items 12 & 13)	350-00-235	350-00-230
41	Gear Cover & Pin Assembly- (Includes Items 12 & 13)	350-00-355	350-00-350
42	Miter Gear	350-00-020	350-00-045
43	Meter Body	350-00-470	350-00-470
44	Rotor	350-00-500	350-00-505
45	Fill. Hd. Mach. Screw #10-24 x 3/8	557-09-635	557-09-635
46	Fill. Hd. Cap Screw #12-24 x 3/8	557-09-640	557-09-640
47	Hex. Hd. Cap Screw 1/4-20 x 1/2	555-11-050	555-11-050
48	Hex. Hd. Cap Screw 1/4-20 x 3/4	555-11-054	555-11-054
49	Lockwasher 1/4	562-03-604	562-03-604
50	Lockwasher - Shakeproof #1210	562-03-634	562-03-634
51	Lockwasher - Shakeproof #1212	562-03-644	562-03-646
52	Groov-Pin "Type 5" 3/32 x 5/8	509-03-940	509-03-940
53	Groov-Pin "Type 5" 3/32 Dia. x 5/8	509-03-940	509-03-936
54	Spiral Pin 1/8 Dia. x 5/8	562-10-144	562-01-144
55	Sq. Hd. Pipe Plug 1/4	501-01-414	501-01-414
56	Truarc Retaining Ring "Type 5133"	504-08-030	504-08-030

COMPLETE METER ASSEMBLY - TEFLON TRIMMED "SP" 250-00-430 250-00-405  
 COMPLETE METER ASSEMBLY - TEFLON TRIMMED "AF" 250-00-435 —

\* If The "Sp" Meter Is Teflon-Trimmed, Use The Part Number Shown In The "AF" Column.  
 WHEN ORDERING PARTS, ALWAYS GIVE THE METER SERIAL NUMBER.